

Data Sheet

FLP-CLS



mGard is the ultimate range of robust **mechanical trapped key products**. Trapped key technology offers purely mechanical access locks (removing the need for expensive wiring). mGard offers an extensive variety of modular interlocking solutions.

description:

a key operated rotary switch for use in areas where explosive flammable gases or dust particles may be present and is usually used for electrical isolation. The standard sequence is power on - key trapped. Once the key is turned and removed the power source is isolated and the key can be taken elsewhere.

operation - the switch can only be operated by the key, which is normally held trapped when the switch is in the ON or 3 o'clock position. With the switch in the OFF or 12 o'clock position the key can be removed and then transferred to another interlock unit within the system.

application - part of an interlock system, the unit is used for control or isolation of electrical circuits operating plant or machinery prior to, for example, carrying out maintenance.

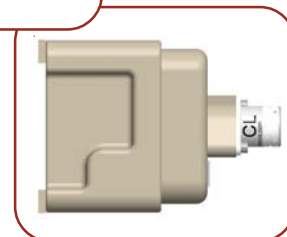

options:

- Part / Stainless Steel Basic Lock CL.
- Master series locks: MLS/ML
- Optional 'Key Free' position
- Optional switch contact configurations (to special order)

www.fortressinterlocks.com

Technical Data

FLP-CLS



Construction

Rating:	EExd IIB T4-T6
For use in:	cat 2 & 3 (Zone 1 & 2) areas
Lock mechanism:	Stainless steel with a durable electro-polish finish to the lock casing
Internals:	All Stainless Steel
Enclosure:	Cast Iron 2 pack epoxy finish, with 2 x M20 ISO entries at the bottom (2 plugged)
Degree of protection:	IP65 (IEC 529)
Standard Switching:	16 380/415V AC 4 Pole On/Off Arrangement or 2/NO, 2/N/C
Keys:	Stainless Steel

Features & Benefits

- Certified to ATEX Directive 94/9/EC
- Direct drive operation - Positively opened contacts
- Available from 6 amps to 63 amps (specials on request)
- Coding can be up to 30 characters
- Over 200,000 non-masterable lock combinations available (specials on request)
- 4NO or 2NO/2NC contacts available (specials on request)

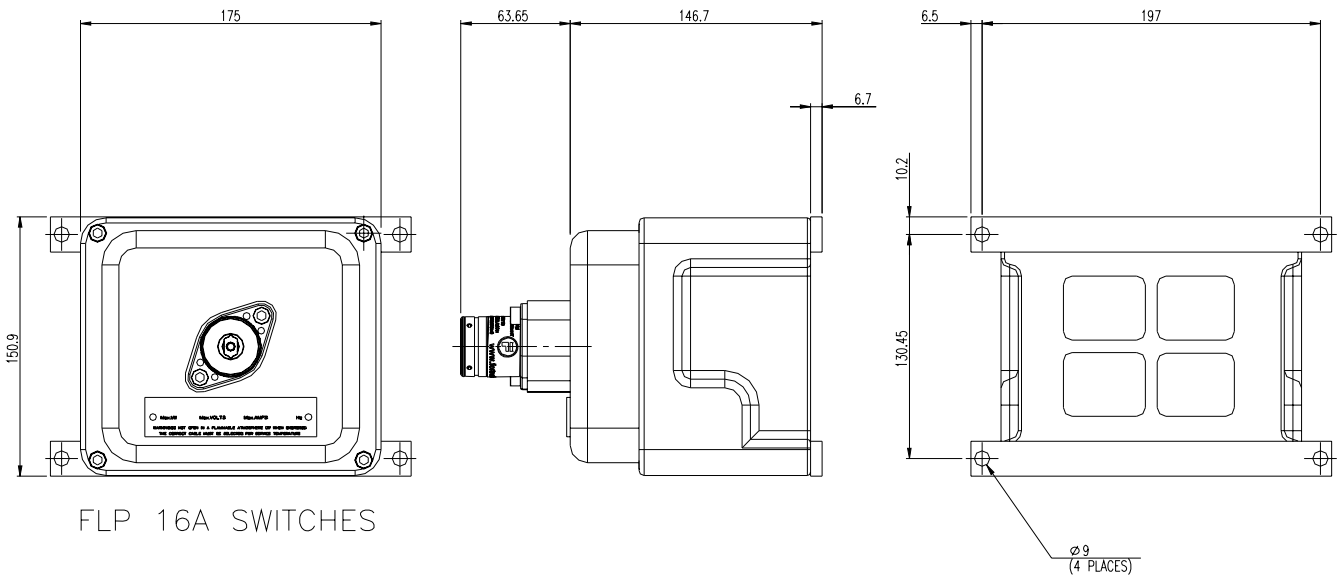

FLP 16A SWITCHES

2NO / 2NC

4NO

